



## PLAN A FALL FIELD TRIP TO FLAMING ACRES FARM

Flaming Acres is opening the farm this fall for field trips. We encourage teachers and parents from elementary schools & homeschool groups to plan a visit. For elementary schools grade Kindergarten through 4th grade admission fee is only \$8 per student. Teachers and chaperones have free admission.



If your group came to Flaming Acres in the spring for a field trip, your students receive a \$2 discount. Teachers and chaperones have free admission.

Opening day is October 4th-October 27th Wednesdays, Thursdays, and Fridays. There are two daily session times to choose from. The morning session is 9:00 a.m.-11:00 a.m. with time for a picnic lunch from 11:00 a.m.-11:30 a.m. The afternoon session is 12:00 p.m.-2:00 p.m. with time for lunch from 11:30 a.m.- 12:00 p.m. To sign up for your date & time scroll down to the online registration form and select your preferred dates and times. Payment is due two weeks prior to the field trip date. One adult chaperone/10 students is the recommended ratio. Younger or special needs students may require a 1/5 student to chaperone ratio. Kindergarten to 3rd grade is the ideal age range for the type of agricultural education experiences designed at the farm.

### WHAT IS INCLUDED WITH THE ADMISSION FEE?

#### **Kindergarten, Elementary, Homeschool School Admission Fee Includes:**

Access to Farm Fun Play Areas: Ziplines Swings, Tractor Tire Playground, Jumbo Jumping Pillow, Pedal Carts, Cow Train or Hay Wagon Ride, Ag Education Stations about Corn, Pumpkins and Farm Animals, Access to Picnic Areas for Lunches/Snacks...

#### **What can you expect when you visit Flaming Acres Farm?**

Groups will kick off their visit with a welcome where students will meet the farmers (Dion & Debbie Flaming), learn fun farm facts, and be introduced to a few safety rules. Teachers or field trip group leaders will be emailed a packet of resources and field trip information before they visit the farm which includes educational materials, a schedule, a map, and other important information to help make the farm visit a successful time for all. Upon arrival, each group leader will be provided directions for navigating through the farm in a sequence with specific time intervals which will keep everyone moving to help avoid the problem of missing an activity or wasting time standing in line. Lunches can be eaten at the end of the visit for morning groups and at the beginning of the visit for the afternoon groups in the picnic areas on the farm.

# FLAMING



# ACRES

Where fun grows!

Note: Not all activities are open for Fall Field Trips.

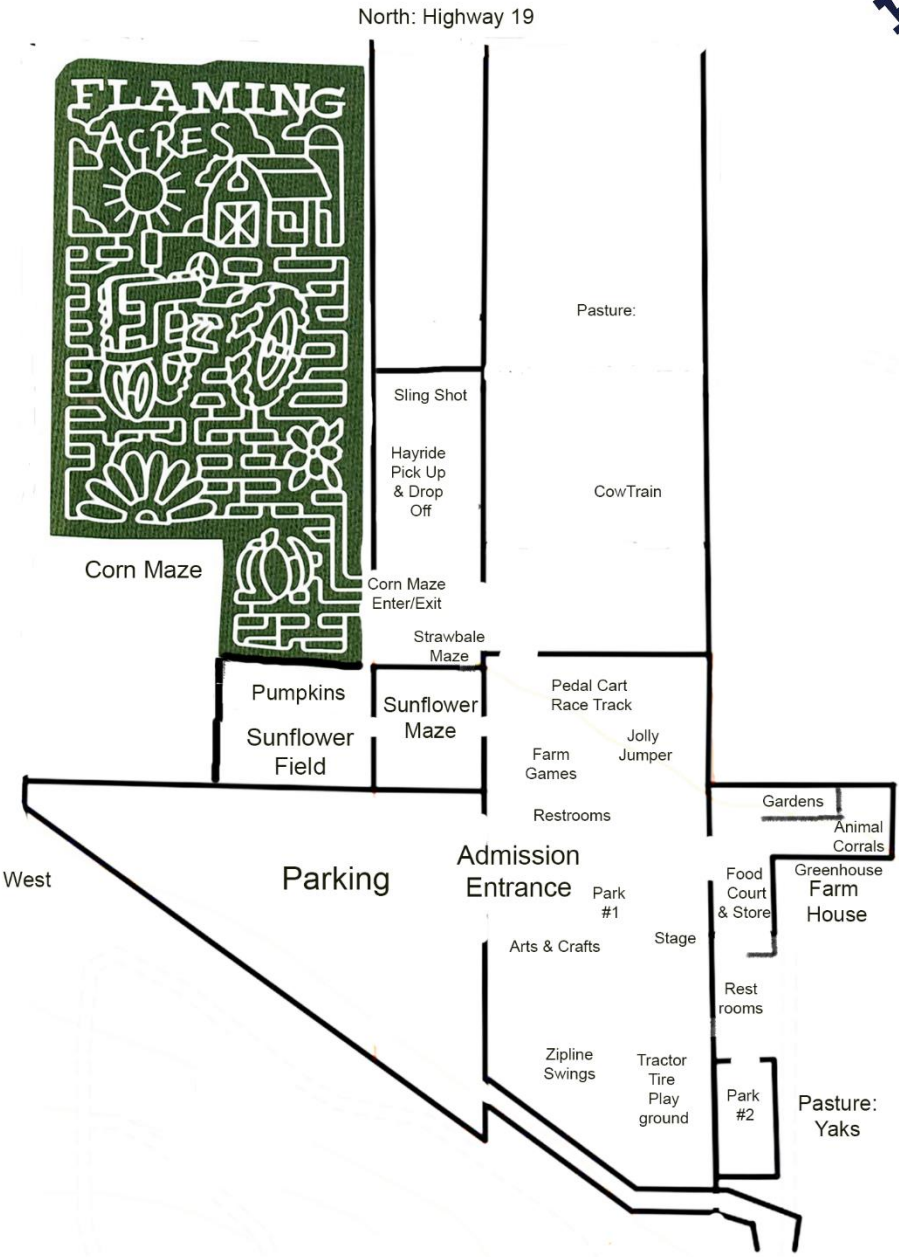

Farm Entrance  
20046 Lower Pleasant Ridge Rd



**Summer:** In the summer months, Admission to the farm is FREE. The farm is open to the public on Saturdays & Sundays from 8 a.m.-2 p.m. for U-Pick Sunflowers with food and fun farm activities July 8<sup>th</sup>- September 3<sup>rd</sup>.

On Labor Day (September 4<sup>th</sup>), the farm hosts a car show and farmer's market event. Again, Admission is free!

**FLAMING ACRES FARM  
SUNFLOWER/FLOWER  
U-PICK SEASON**

**JULY 8<sup>th</sup> - SEPT 3<sup>rd</sup>  
Saturdays & Sundays 8 am- 2 pm**

**U-PICK SUNFLOWERS  
GARDEN CUT FLOWERS  
BOUQUETS \$  
ART CLASSES \$  
FOOD & BEVERAGES \$**

**FREE ADMISSION:  
MUSIC  
WALKING PATHS  
FARM ANIMAL ZOO  
PARK & PLAY AREAS**

20046 Lower Pleasant Ridge Rd  
Caldwell, Idaho 83607  
(208) 630-4049

**FLAMING ACRES FARM  
FALL  
Harvest Festival**

CORN MAZE HAY MAZE  
HAY RIDES MUSIC COW TRAIN  
PETTING ZOO PUMPKIN PATCH

**DATES**  
SATURDAY SEPT 16<sup>th</sup> - SUNDAY  
OCT 29<sup>th</sup>

OPEN: 10 am-6 pm

**ADMISSION: \$15 Adults \$10 Kids (ages 4-11), Free 3 & Under**

20046 LOWER PLEASANT RIDGE CALDWELL, ID  
BRING YOUR FAMILY FOR SOME FALL FUN YA'ALL!

---

September 16<sup>th</sup>-October 29<sup>th</sup>

**FLAMING ACRES FARM  
COUPON**

OPEN  
Sat 10 am-6 pm  
Sun 10 am-6 pm  
www.flamingacres.com

**ENJOY 20% OFF Admission**

20046 Lower Pleasant Ridge Rd Caldwell, ID  
This Coupon is good for families or individuals...so SHARE!

Corn Maze  
Pumpkin Patch  
Hayrides  
Cow Train  
Farm Games  
Petting Zoo  
Jumping  
Fishes  
Ziplines...

The Fall Harvest Festival season opens to the public on September 16<sup>th</sup>-October 29<sup>th</sup> on Saturdays & Sundays 10 am-6 pm. Included in the teacher packet are flyers and coupons with 20% discount coupons to share with everyone!